

This document is subject to change without notice
This document is the exclusive property of DETI SAS and cannot be communicated to third parties or reproduced without prior written permission

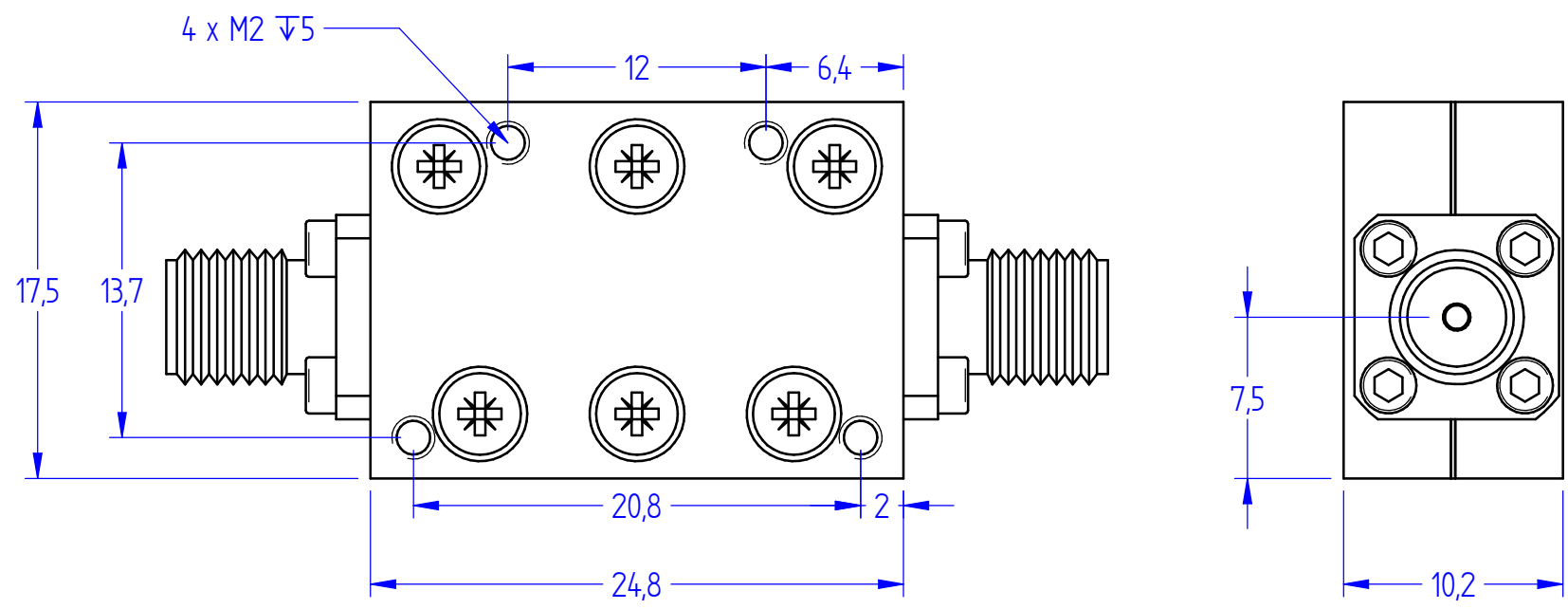
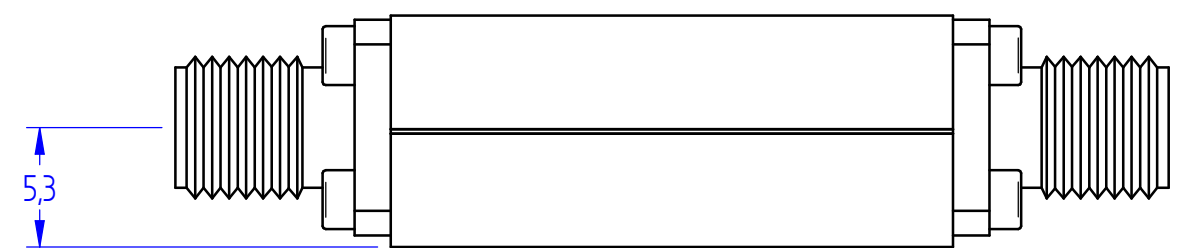
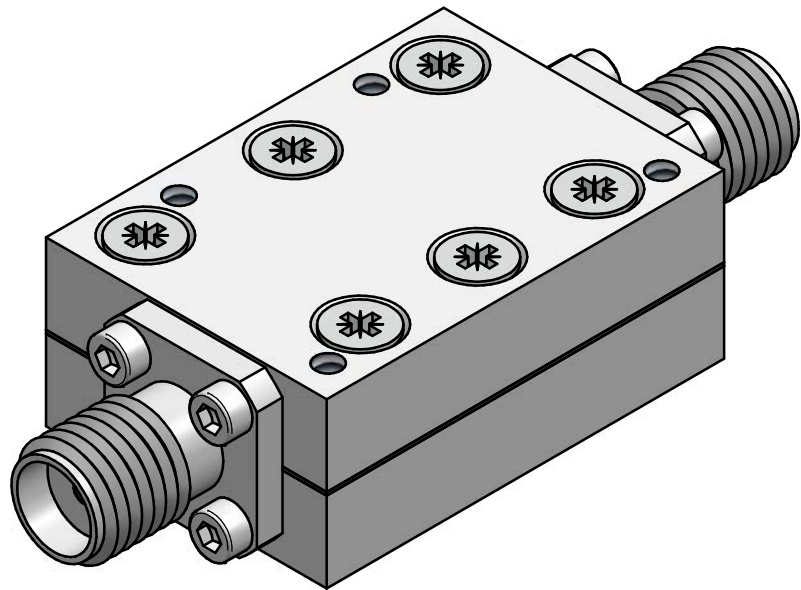

TECHNICAL SPECIFICATIONS

- Frequency Range :** 3300 - 18000 MHz
- Insertion Loss :** < 3.0 dB @ 2900 - 3300 MHz
< 1.0 dB @ 3300 - 18000 MHz
- VSWR :** < 2.0 :1 @ 3300 - 18000 MHz
- Rejection :** > 45 dB @ DC - 2600 MHz
- Max. Input Power :** 2 W CW
- Operating Temperature :** -40°C to +85°C
- Storage Temperature :** -55°C to +125°C

Input Connector : SMA Female
Output Connector : SMA Female

| | | | | | | | | | | |
|------------------------------------|----------|------------|------------|-----------|------------|------------|---------------------------|-------------|--|-------------------|
| Last rev. additional information : | | | | | | | Material : Aluminium | | Titre : FILTRE PASSE HAUT 3.3-18 GHZ - 19 POLES | |
| | | | | | | | Treatment : Silver plated | | Title : HIGH PASS FILTER 3.3-18 GHZ - 19 POLES | |
| | | | | | | | Finish : - | | Comment : HPF-SS-2600-45-3300-18000-SF-SF | |
| | | | | | | | Gen. Tol. : ISO 2768 - mK | | Document Number : 800272 1501A | |
| | | | | | | | Orientation : | | Date : 22/02/2021 | |
| A | Création | S. Mellaza | 22/02/2021 | W.Kherraz | 22/02/2021 | S. Mellaza | 15/04/2021 | Size : A3 | Classif. : 2 | Drawn : smellaza |
| Rev. | Change | Drawn | Date | Check | Date | Approb. | Date | Scale : 3:1 | Sheet : 1 / 1 | Date : 22/02/2021 |

